

LAS & LASC Series

Technical Data:

Aluminum

- Extrusion – C/S uses multiple alloys & tempers which are established to be the most appropriate for the given use of individual parts. Will be one of the following: (6063-T5, T6, T52) (6061-T5, T6, T51) (6105-T5, T6) (6005-T5) (6005A-T5, T6), ASTM B221
- Sheet – 6061-T6, 3003-H14, 5005-H34, ASTM B209
- Honeycomb panels
- Skins 3003+
- Core 3031-H14

Product Description:

This flush wall and ceiling cover is designed for large joints where minimal visibility is desired. Unique attachment design allows for thermal expansion and allows panel to disengage during a seismic event to prevent damage to surrounding walls.

Use This Cover For:

- Large seismic joints where concealment is desired.
- Suitable for most wall & ceiling finishes including demountable panels.

Performance Characteristics:

The LAS cover is factory primed can be field painted to match almost any finish and disengages from wall on shock cords for full movement.

Standard Finishes:

Clear anodize on any exposed aluminum. Cover plate supplied with clear epoxy primer and can be field painted to match adjacent wall and ceiling finishes.

Installation Guidelines:

Attach the aluminum retainers to wall using mechanical fasteners. Cut finish panels to match retainers. Attach spring clip to back of panel connecting to pre-tensioned shock cord. Panels are attached to retainers with heavy duty hook and loop fasteners. There are some great tips in the complete C/S installation instructions. For the complete installation instructions, please visit www.c-sgroup.com.

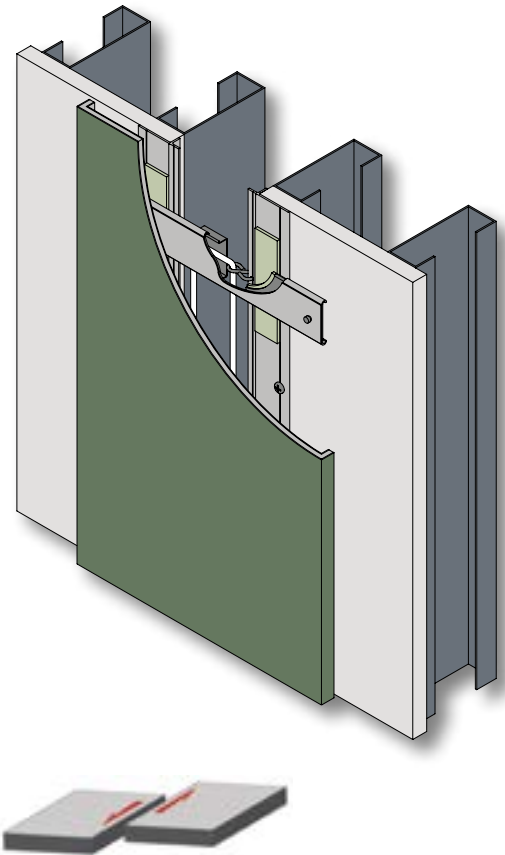

Capable of Lateral Movement

MODEL	JOINT WIDTH	MINIMUM OPENING	MAXIMUM OPENING	EXPOSED SURFACE	BLOCKOUT WIDTH	BLOCKOUT HEIGHT
LAS-400	4.00" (102mm)	1.00" (25mm)	8.00" (203mm)	11.00" (279mm)	N/A	N/A
LAS-500	5.00" (127mm)	1.00" (25mm)	10.00" (254mm)	12.00" (305mm)	N/A	N/A
LAS-600	6.00" (152mm)	1.00" (25mm)	12.00" (305mm)	13.00" (330mm)	N/A	N/A
LAS-700	7.00" (178mm)	1.00" (25mm)	14.00" (356mm)	14.00" (356mm)	N/A	N/A
LAS-800	8.00" (203mm)	1.00" (25mm)	16.00" (406mm)	15.00" (381mm)	N/A	N/A
LAS-900	9.00" (229mm)	1.00" (25mm)	18.00" (457mm)	16.00" (406mm)	N/A	N/A
LAS-1000	10.00" (254mm)	1.00" (25mm)	20.00" (508mm)	17.00" (432mm)	N/A	N/A
LAS-1100	11.00" (279mm)	1.00" (25mm)	22.00" (559mm)	18.00" (457mm)	N/A	N/A
LAS-1200	12.00" (305mm)	1.00" (25mm)	24.00" (610mm)	19.00" (483mm)	N/A	N/A
LAS-1300	13.00" (330mm)	1.00" (25mm)	26.00" (660mm)	20.00" (508mm)	N/A	N/A
LAS-1400	14.00" (356mm)	1.00" (25mm)	28.00" (711mm)	21.00" (533mm)	N/A	N/A
LAS-1500	15.00" (381mm)	1.00" (25mm)	30.00" (762mm)	22.00" (559mm)	N/A	N/A
LAS-1600	16.00" (406mm)	1.00" (25mm)	32.00" (813mm)	23.00" (584mm)	N/A	N/A
LAS-1700	17.00" (432mm)	1.00" (25mm)	34.00" (864mm)	24.00" (610mm)	N/A	N/A
LAS-1800	18.00" (457mm)	1.00" (25mm)	36.00" (914mm)	25.00" (635mm)	N/A	N/A
LAS-1900	19.00" (483mm)	1.00" (25mm)	38.00" (965mm)	26.00" (660mm)	N/A	N/A
LAS-2000	20.00" (508mm)	1.00" (25mm)	40.00" (1,016mm)	27.00" (686mm)	N/A	N/A
LAS-2100	21.00" (533mm)	1.00" (25mm)	42.00" (1,067mm)	28.00" (711mm)	N/A	N/A
LAS-2200	22.00" (559mm)	1.00" (25mm)	44.00" (1,118mm)	29.00" (737mm)	N/A	N/A
LAS-2300	23.00" (584mm)	1.00" (25mm)	46.00" (1,168mm)	30.00" (762mm)	N/A	N/A
LAS-2400	24.00" (610mm)	1.00" (25mm)	48.00" (1,219mm)	31.00" (787mm)	N/A	N/A

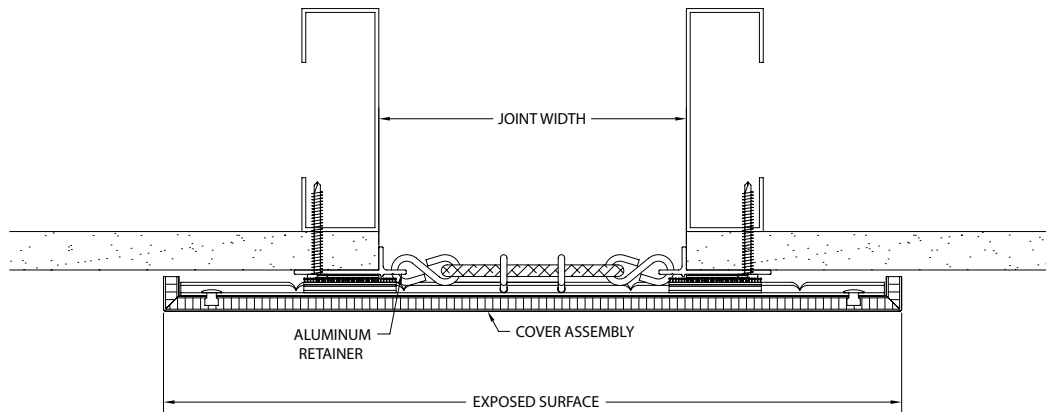

LAS

MODEL	JOINT WIDTH	MINIMUM OPENING	MAXIMUM OPENING	EXPOSED SURFACE	BLOCKOUT WIDTH	BLOCKOUT HEIGHT
LASC-400	4.00" (102mm)	2.50" (64mm)	8.00" (203mm)	7.50" (191mm)	N/A	N/A
LASC-500	5.00" (127mm)	2.50" (64mm)	10.00" (254mm)	8.50" (216mm)	N/A	N/A
LASC-600	6.00" (152mm)	2.50" (64mm)	12.00" (305mm)	9.50" (241mm)	N/A	N/A
LASC-700	7.00" (178mm)	2.50" (64mm)	14.00" (356mm)	10.50" (267mm)	N/A	N/A
LASC-800	8.00" (203mm)	2.50" (64mm)	16.00" (406mm)	11.50" (292mm)	N/A	N/A
LASC-900	9.00" (229mm)	2.50" (64mm)	18.00" (457mm)	12.50" (318mm)	N/A	N/A
LASC-1000	10.00" (254mm)	2.50" (64mm)	20.00" (508mm)	13.50" (343mm)	N/A	N/A
LASC-1100	11.00" (279mm)	2.50" (64mm)	22.00" (559mm)	14.50" (368mm)	N/A	N/A
LASC-1200	12.00" (305mm)	2.50" (64mm)	24.00" (610mm)	15.50" (394mm)	N/A	N/A
LASC-1300	13.00" (330mm)	2.50" (64mm)	26.00" (660mm)	16.50" (419mm)	N/A	N/A
LASC-1400	14.00" (356mm)	2.50" (64mm)	28.00" (711mm)	17.50" (445mm)	N/A	N/A
LASC-1500	15.00" (381mm)	2.50" (64mm)	30.00" (762mm)	18.50" (470mm)	N/A	N/A
LASC-1600	16.00" (406mm)	2.50" (64mm)	32.00" (813mm)	19.50" (495mm)	N/A	N/A
LASC-1700	17.00" (432mm)	2.50" (64mm)	34.00" (864mm)	20.50" (521mm)	N/A	N/A
LASC-1800	18.00" (457mm)	2.50" (64mm)	36.00" (914mm)	21.50" (546mm)	N/A	N/A
LASC-1900	19.00" (483mm)	2.50" (64mm)	38.00" (965mm)	22.50" (572mm)	N/A	N/A
LASC-2000	20.00" (508mm)	2.50" (64mm)	40.00" (1,016mm)	23.50" (597mm)	N/A	N/A
LASC-2100	21.00" (533mm)	2.50" (64mm)	42.00" (1,067mm)	24.50" (622mm)	N/A	N/A
LASC-2200	22.00" (559mm)	2.50" (64mm)	44.00" (1,118mm)	25.50" (648mm)	N/A	N/A
LASC-2300	23.00" (584mm)	2.50" (64mm)	46.00" (1,168mm)	26.50" (673mm)	N/A	N/A
LASC-2400	24.00" (610mm)	2.50" (64mm)	48.00" (1,219mm)	27.50" (699mm)	N/A	N/A

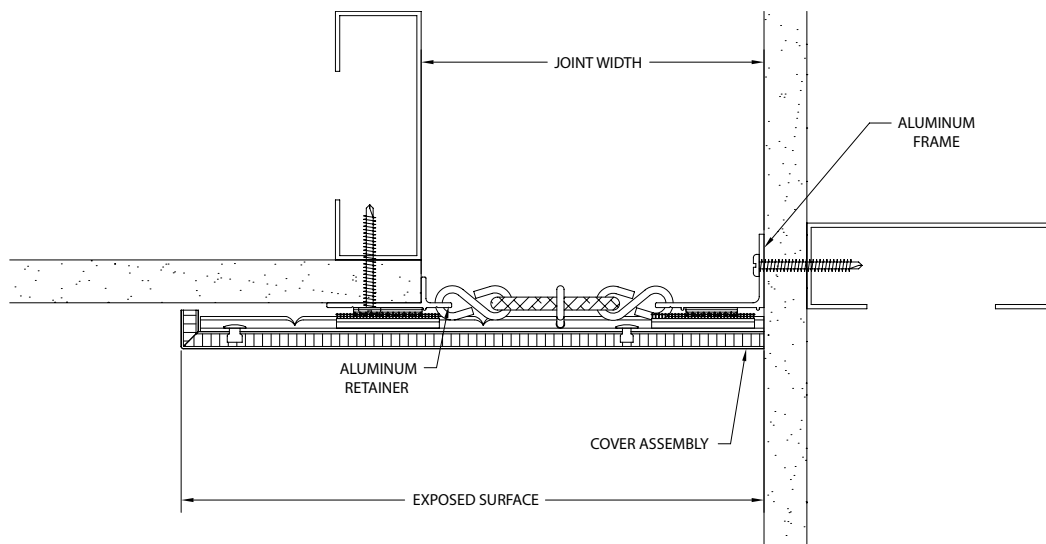

LASC